



## INSTALLATION and MAINTENANCE INSTRUCTIONS for GLEASON CABLE-MASTER REEL

### Reel Consists of Four Basic Sections:

- Frame Assy - Includes Junction Box and Shaft
- Spring Assy
- Spool Assy - Includes Cable and Connector
- Slip Ring Assy

### I. Reel Installation

- A. Mounting:** Reel is mounted by securing base to mounting surface using four 3/8 screws. Reel must be mounted with shaft horizontal and spool center in line with cable run.
- B. Cable Guide:** Four roller guide is standard equipment and may be used in any of four positions. Cable must pay off reel in a straight line without any sharp bends. Procedure to set roller guide position:
1. Remove junction box cover.
  2. Remove 3/8-16 screws & lock washers holding guide arm mounting bracket.
  3. Remove 3/8-16 screw, lockwasher & nut inside junction box at selected position.
  4. Replace guide arm mounting bracket in selected position.
  5. Replace 3/8-16 screw, lockwasher & nut
6. Loosen 3/8 screw holding roller guide and rotate roller guide if necessary. Tighten 3/8 screw.
- C. Holding Dog:** Ratchet and dog are standard equipment and are shipped in the "engaged" position. If constant tension is required disengage holding dog by removing #10 slotted screw, rotating selector plate to "disengaged" position and replacing #10 slotted screw.
- D. Wiring Connections:** Input connections are made in junction box thru conduit threaded into junction box coupling (Coupling can be rotated to four positions). Join input wires to numbered slip ring wires using wire nut connectors. If reel is to be grounded one numbered slip ring wire must be attached to grounding lug in junction box.
- E. Adjusting Spring Tension:** Reel must be pretensioned before making output connections. Pretension reel by rotating spool in clockwise direction (as viewed from slip ring cover end). The number of turns indicated by the last one or two digits in the reel model number. Pull cable off spool to desired length, at least one turn of cable should remain on spool. See that spring does not run out of turns. Otherwise spring will be damaged or spring life will be drastically shortened. Engage holding dog or otherwise prevent spool from turning and complete final out put connections.
- F.** Before turning on electrical power and placing reel in service, check all wiring for short circuits and continuity.

## II. Servicing Reel

**A. Spring Replacement:** If reel loses tension and fails to rewind cable onto spool this indicates spring is broken and must be replaced. To replace spring follow this procedure:

1. Turn off all electric power.
2. Disconnect input and output wiring.
3. Rewind cable onto spool by rotating spool in a counter clockwise direction (As viewed from slip ring cover end). Ensure all tension is off spring.
4. Remove clamp nut (inside junction box) by loosening socket head screw using a 3/16 Hex Allen wrench, and spin off clamp nut while supporting spool.
5. Remove entire spool assy from frame.
6. Remove ring and seals from shaft.
7. Remove #10 locknuts holding spring assy to spool and pull spring assy off shaft.
8. Replace new spring assy in reverse order to reassemble reel.
9. Adjust spring tension following procedure I E and place reel back in service.

### B. Slip Ring Replacement:

1. Turn off all electric power.
2. Disconnect input wiring in junction box.

3. Remove #10 locknuts holding slip ring cover and gasket.
4. Disconnect cable leads from slip ring terminals.
5. Loosen two set screws in collar using a 1/8 Hex Allen wrench.
6. Pull slip ring assy off shaft.
7. Replace new slip ring assy in reverse order.

### C. Cable Replacement:

1. Turn off all electric power.
2. Disconnect output wiring and allow cable to retract onto spool. Ensure all tension is off spring.
3. Remove cable from spool by slipping cable off spool and over slip ring housing.
4. Remove slip ring cover.
5. Disconnect cable leads from slip ring terminals.
6. Loosen counternut on cable connector (inside slip ring housing) and pull cable out of spool.
7. Replace new cable in reverse order. Rewind cable onto spool by laying out cable in a straight line then rotating spool in a counter clockwise direction (As viewed from slip ring housing end).
8. Adjust spring tension following procedure I E and place reel back in service.



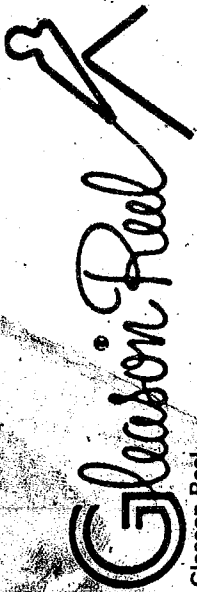

Gleason Reel

Mayville, Wisconsin 53050 Phone (414) 387-4120 Telex 26-753

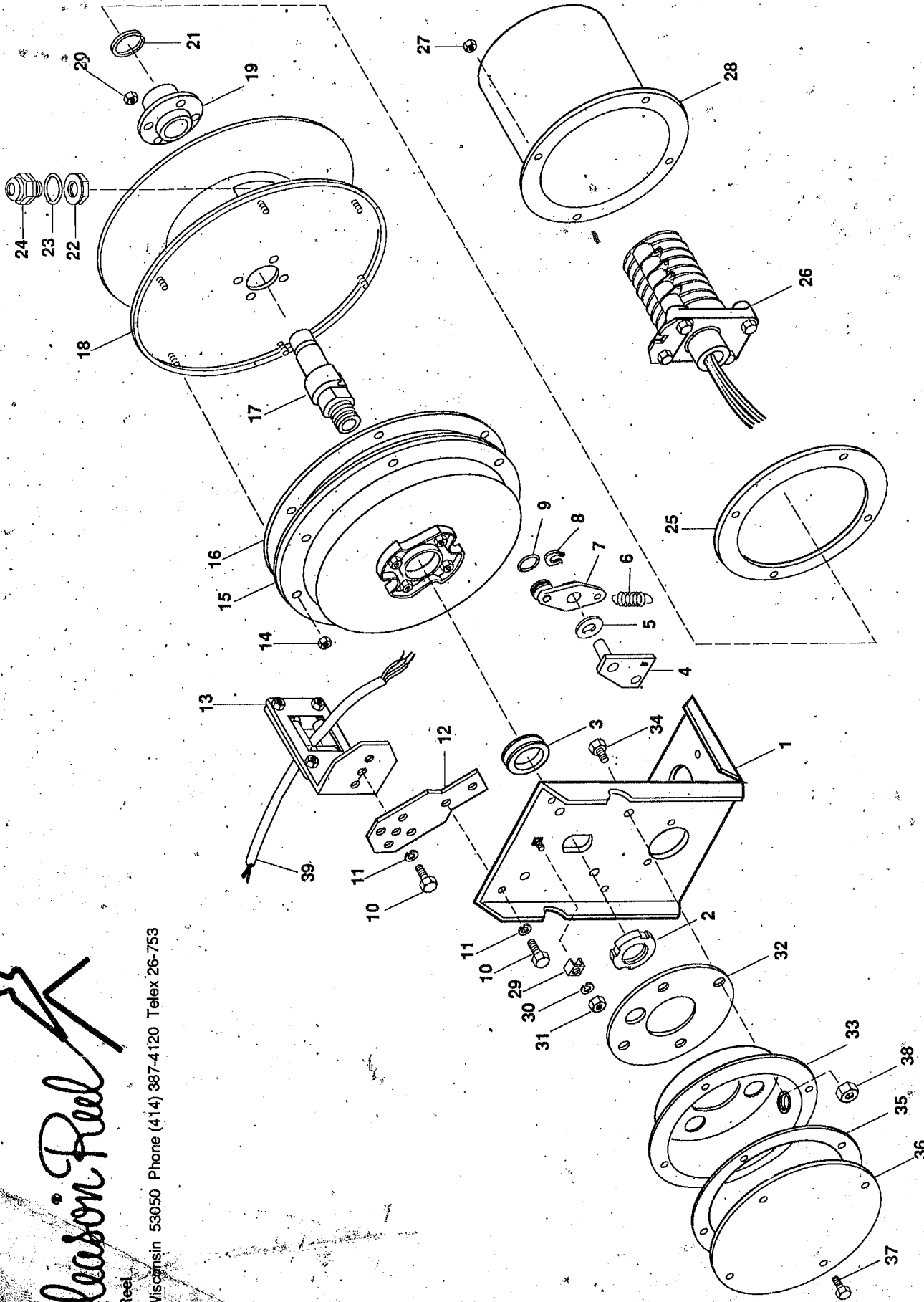

**Bulletin CM-14**  
Covers Reels Manufactured After Jan. 1, 1988  
**CM-14 Electric Cable Reel Replacement Parts List**  
January, 1988

Always Specify Serial Number & Model Number When Ordering Parts

Printed in U.S.A.

# CM-14 Electric Cable Reel Replacement Parts List

Covers Reels Manufactured After January 1, 1988

ITEM	PART NO.	DESCRIPTION	QTY.
1	021456	Frame Assembly	1
2	021484	Clamp Nut	1
3	025032	V-Ring Seal	1
4	021459	Selector Plate	1
5	016583	Flat Washer, .38	1
6	023945	Spring, Extension	1
7	024633	Locking Dog Assembly	1
8	021463	Grip Ring	1
9	024636	O-Ring	1
10	101354	Hex Head Capscrew, .38-16 x .88	3
11	101093	Lockwasher, .38	3
12	021527	Mount Bracket	1
13	024466	Roller Guide Assembly	1
14	101232	Lock Nut, #10-32	6
15	021488	Spring Assembly S1	1
	021490	Spring Assembly S2	1
	021492	Spring Assembly S3	1
16	021494	Spring Gasket	1
17	021473	Shaft	1
18	021465	Spool Assembly	1
19	024502	Flange Bushing	1
20	101232	Lock Nut, #10-32	4
21	107185	Retaining Ring	1
22	021513	Counter Nut	1

ITEM	PART NO.	DESCRIPTION	QTY.
23	104336	O-Ring	1
24	022805	Cable Connector, .38 - .50 Dia. Cable	1
	021510	Cable Connector, .50 - .70 Dia. Cable	1
	021511	Cable Connector, .70 - 1.00 Dia. Cable	1
25	018042	Cover Gasket	1
26	021520	Collector Assembly, 1 - 4 Pole, 30A	1
	021521	Collector Assembly, 5 - 8 Pole, 30A	1
	021522	Collector Assembly, 9 - 12 Pole, 30A	1
	021543	Collector Assembly, 1 - 4 Pole, 55A	1
27	101232	Lock Nut, #10-32	4
28	02149603	Collector Cover, 1 - 4 Pole	1
	02149604	Collector Cover, 5 - 8 Pole	1
	02149605	Collector Cover, 9 - 12 Pole	1
29	01555101	Grounding Lug	1
30	022453	Lockwasher, Internal Tooth #10	1
31	101232	Lock Nut, #10-32	1
32	021479	Gasket, Junction Box	1
33	021480	Junction Box	1
34	101353	Hex Head Capscrew, .38-16 x .63	3
35	018042	Cover Gasket	1
36	018043	Junction Box Cover	1
37	117685	Tapite Screw, .25 x .63	4
38	101346	Lock Nut, .38-16	3
39	See Nameplate	† Cable per Catalog No.	1

† i.e. -3A30 = 30 ft. of 3/C #16AWG

## Optional Accessories

Part No.	Description	Qty.
022450	Cable Stop, .38 - .50 Dia.	Option
022451	Cable Stop, .50 - .75 Dia.	Option
022452	Cable Stop, .75 - 1.00 Dia.	Option
022217	Swivel Base, CM-14	Option