

**Professional Service Equipment**



3501 S. Leonard Rd.  
 P.O. Box 728  
 St. Joseph, Missouri 64502  
 U.S.A.  
 Toll Free: (800) 821-7320  
 Phone: (816) 233-6121  
 Fax: (816) 233-7251  
 Email: [gray@grayusa.com](mailto:gray@grayusa.com)  
[www.grayusa.com](http://www.grayusa.com)

# Parts List

## TSJ-55 Truck Scissors Jack

Item	Qty	Part Number	Description
1	2	2-807-02009	Pad Arm Weldment
2	1	2-807-02004	Table Weldment
3	8	0-204-11201	Lock Washer, 3/8"
4	5	0-203-01200	Nut, Hex, 3/8-16 UNC
5	2	2-480-50036	Low Saddle Weldment
6	2	2-480-50037	High Saddle Weldment
7	1	0-200-31218	Capscrew, Hex, 3/8-16 UNC
8	1	1-807-02008	Front Pin Weldment
9	1	1-230-14002	Retaining Ring, External, 1 1/4"
10	2	1-441-13002	Bearing, 1 1/4" Dia., 1" Long
12	2	1-441-14001	Bearing, 1 1/2" Dia., 1" Long
13	1	2-807-02002	Center Frame
14	2	1-441-12008	Bearing, 1" Dia., 3/4" Long
15	2	1-807-04024	Leveling Link
16	6	1-441-11003	Bearing, 3/4" Dia., 1/2" Long
17	4	1-204-01701	Washer, 3/4" Dia.
18	4	1-230-12005	Retaining Ring, External 3/4"
19	1	0-275-11001	Elbow, 1/4" 90° Street
20	1	1-275-01021	Nipple, 1/4", 12 7/8" Long
21	1	2-312-01006	Valve, Long Handle
22	2	2-801-04001	Saddle Pin
23	2	1-232-20005	Handle Grip, 5/8 x 3 1/2"
24	1	1-230-11000	Retaining Ring External 1/2"
25	1	1-204-01401	Washer 1/2"
26	1	2-807-02021	Lifting Adapter, L.H. (Optional)
27	1	2-807-02020	Lifting Adapter, R.H. (Optional)
28	1	2-807-02001	Piston Rod Weldment
29	2	1-441-11000	Bearing 3/4" Dia., 3/4" Long

Item	Qty	Part Number	Description
30	2	1-807-02015	Cylinder Pin Weldment
31	1	3-807-02005	Lower Head Plate Weldment
32	1	3-807-02003	Outer Frame
33	2	1-480-00007	Front Wheel
34	4	1-441-24001	Flanged Bearing 1 1/2" Dia.
35	2	1-204-02301	Washer 1 1/2" Dia.
36	2	1-230-14001	Retaining Ring, External 1 1/2"
37	1	1-470-16001	Center Shaft
38	2	0-200-31214	Capscrew, Hex Head 3/8-16 UNC
39	2	0-235-00003	Cotter Pin 1/8" Dia. 1 1/4" Long
40	4	0-204-01700	Washer 3/4" Dia.
41	2	1-480-02003	Wheel Pneumatic
42	1	3-807-02006	Cylinder Weldment
43	3	0-204-11901	Lockwasher 1"
44	3	0-200-31910	Capscrew, Hex Head 1" -8 UNC
45	1	2-391-05005	Cup, 10" Dia.
46	1	1-390-15004	Wiper Ring
47	2	0-200-31204	Capacrew, Hex Head, 3/8-16 UNC
49	1	0-200-31207	Capscrew, Hex Head, 3/8-16 UNC
50	1	3-807-02011	Valve Cover
51	2	1-232-20011	Handle Grip, 7/8" x 5"
52	1	3-800-04001	Safety Catch Hinge
53	1	1-807-02007	Release Rod
54	2	0-203-51200	Push Nut 3/8" Dia.
55	2	0-235-00010	Cotter Pin 3/16" Dia., 1 3/4" Long
56	1	1-470-14003	Rear Axle
57	2	2-480-00017	Rear Wheel, 4" Dia.
58	2	1-204-01902	Washer 1" Dia.

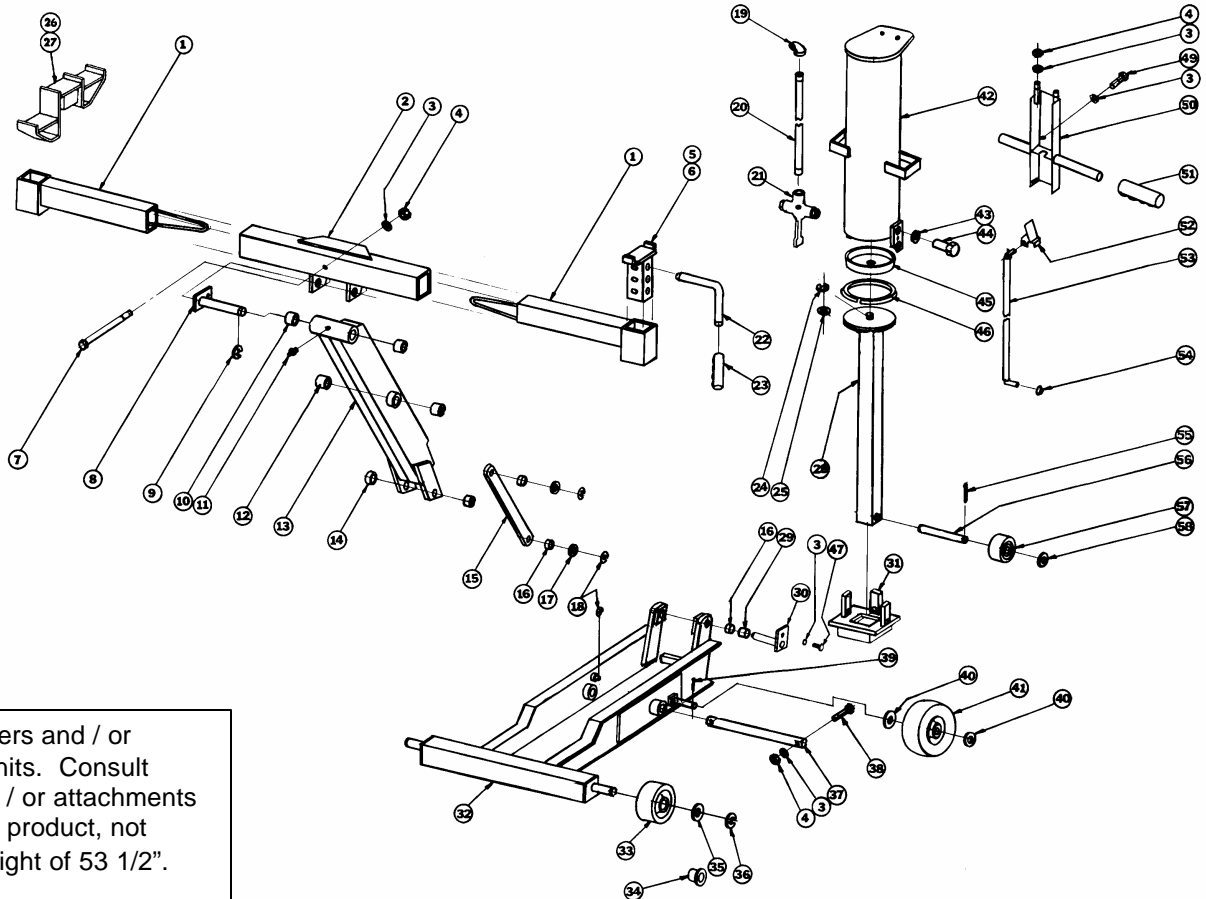

**Notice:** Do not use adapters and / or attachments from other units. Consult parts list for adapters and / or attachments that can be used with this product, not exceed a maximum lift height of 53 1/2".